

DESCRIPTION	REVISIONS	DATE

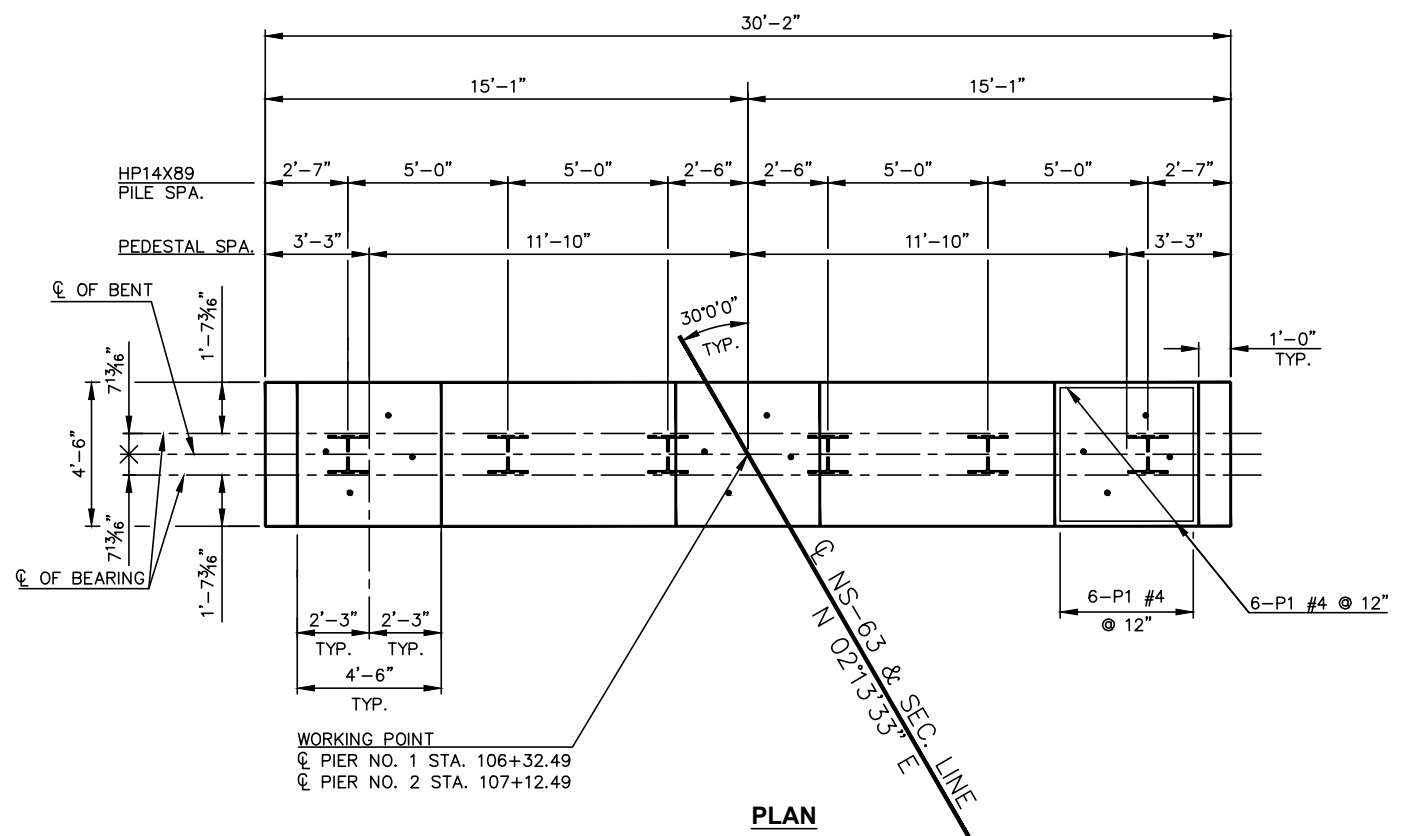

ITEM	UNIT	BENT NO. 1	BENT NO. 2	TOTAL
STRUCTURAL STEEL	L.B.	1,430	1,430	2,860
CLASS A CONCRETE	C.Y.	25.7	25.7	51.4
REINFORCING STEEL	L.B.	2,220	2,220	4,440
PILES, FURNISHED (HP14X89)	L.F.	426	390	816
PILES, DRIVEN (HP14X89)	L.F.	426	390	816

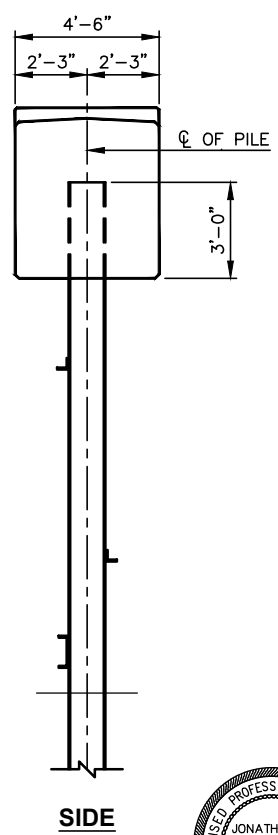
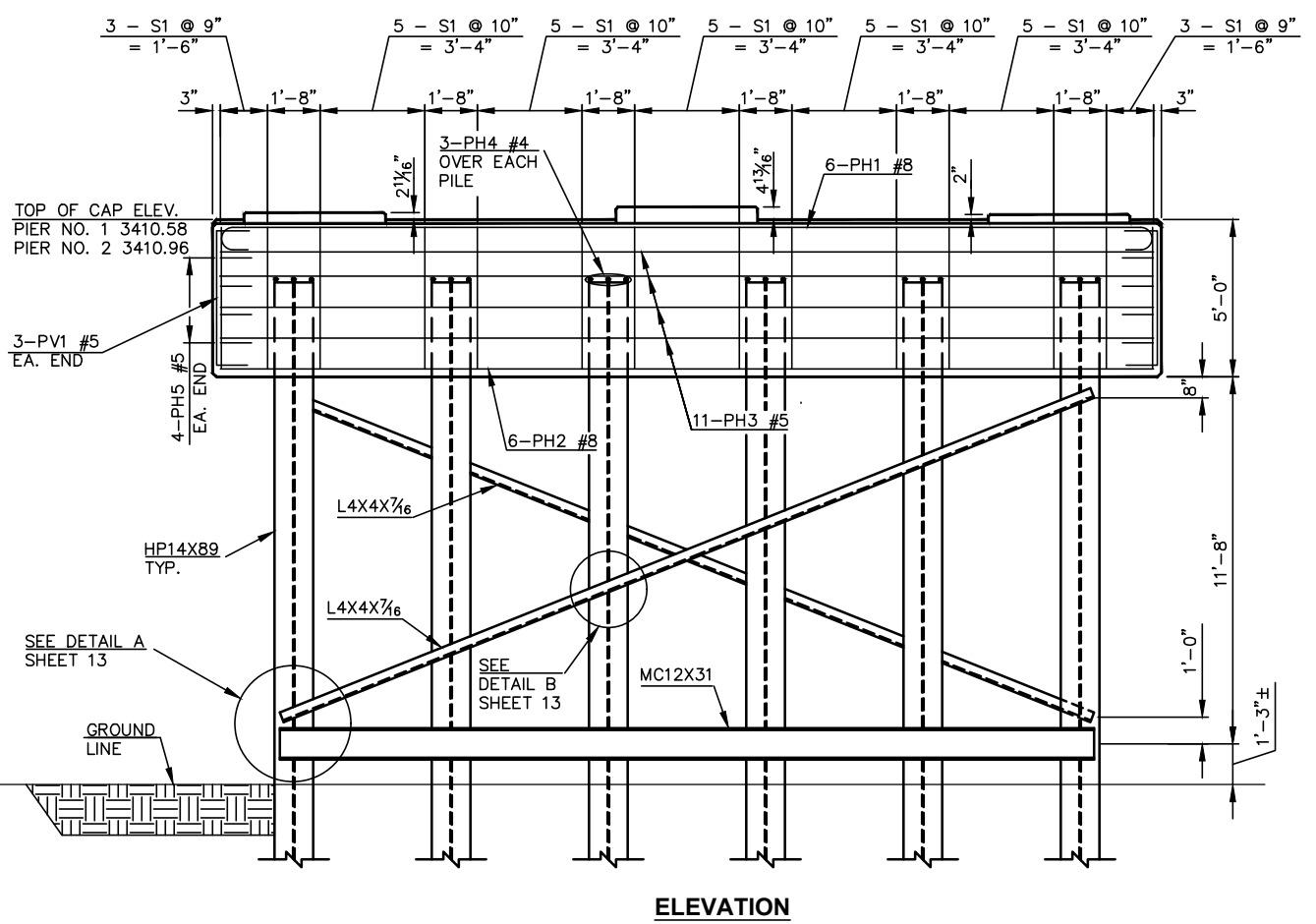

ONE SHOWN, TWO REQUIRED				
PLAIN REINFORCING				
MARK	SIZE	NO.	FORM	LENGTH
P1	#4	36	BNT.	6'-2"
PH1	#8	6	BNT.	31'-8"
PH2	#8	6	STR.	29'-10"
PH3	#5	11	STR.	29'-10"
PH4	#4	18	BNT.	5'-4"
PH5	#5	8	BNT.	5'-9"
PV1	#5	6	BNT.	6'-1"
S1	#5	31	BNT.	18'-4"

NOTE:
FOR TYPICAL SECTION THRU CAP, PEDESTAL PLAN,
PILE SPLICE DETAIL AND BAR BENDS SEE SHEET 13.

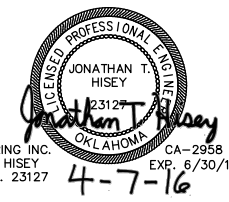

MKEC ENGINEERING INC.
JONATHAN T. HISEY
OKLA. REG. NO. 23127
4-7-16

DESIGN	J.T.H.	NS-63 OVER SAND CREEK	TEXAS COUNTY
DRAWN	T.R.M.	BENT DETAILS SHEET 1 OF 2	
CHECKED	J.T.H.		
APPROV.	J.T.H.		
SQUAD	MKEC ENG.		
JOB PIECE NO. 30490(04)		SHEET NO. B002	

PLOTTED: Friday, August 04, 2017 @ 11:43AM G:\projects\2015\1503010824-CED 8 Texas County Sand Creek Pier Design\5-Civil\CAD\Structural\BENT DETAILS 1 OF 2.dwg